



The Art and Science of Sound

H2EA Horn Flare

Specification

TYPE	EXPONENTIAL
THROAT SIZE	2", 51mm
DISPERSION	60° x 40°
LOWEST REC. X-OVER	700Hz
WIDTH/HEIGHT/DEPTH	12.4" x 7.3" x 6.1"
WIDTH/HEIGHT/DEPTH (mm)	315 x 185 x 155mm
CUT OUT	11.3" x 6.3" (287mm x 160mm)
WEIGHT	4.9 lbs (2.24kg)
VOLUME DISPLACE	131.95in ³

APPROVED VENDOR LIST		
VENDOR	DATE	APPROVED BY
305	8-25-10	M.M.

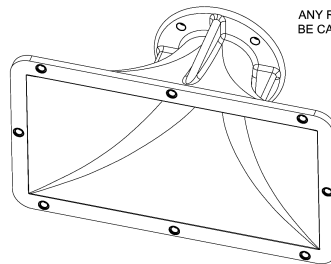
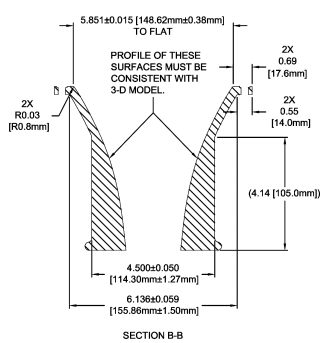

DATE	SYM	REVISION RECORD	DR	CHK	REV
1-18-11	A	DRAWING NUMBER WAS 58023. (PURCHASE REQUEST)	K/A		S.M.
11-07-10	B	3.346±0.011 [84.95mm±0.28mm] WAS 1.115±0.011 [28.33mm±0.28mm], IN ERROR.	K/A		M.M.

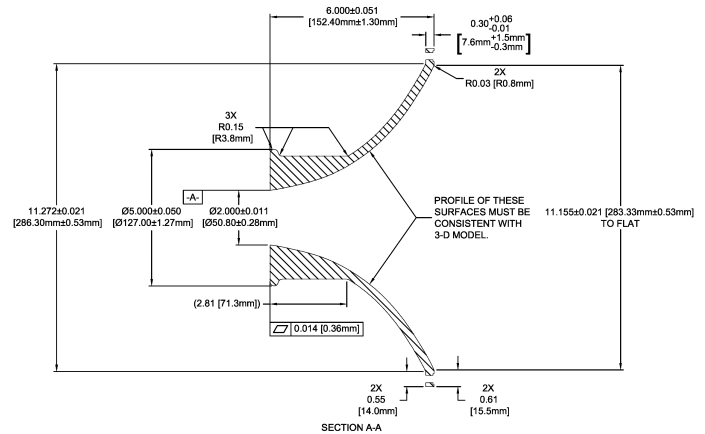
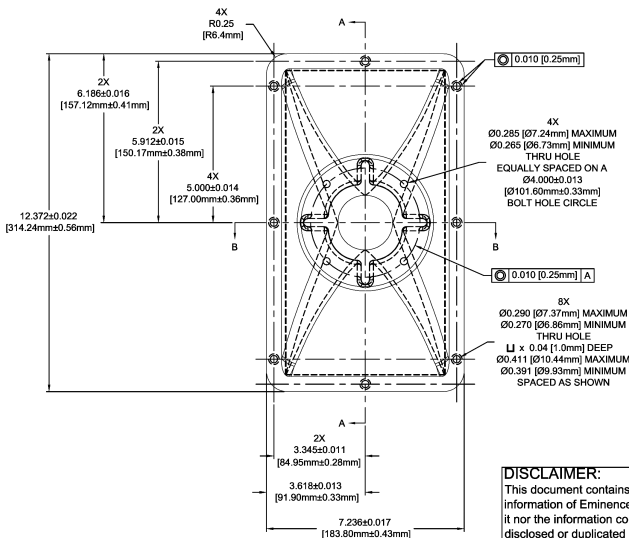

ESTIMATED WEIGHT: 4.9lbs (2.24kg)

MATERIAL: CAST ALUMINUM
FINISH: BLACK SEMI-SANDING POWDER COATING

DISCLAIMER:
This document contains confidential and proprietary information of Eminence Speaker L.L.C. and neither it nor the information contained therein shall be disclosed or duplicated or used by others without the express written consent of Eminence Speaker L.L.C.

ALL SAMPLES AND PRODUCTION QUANTITIES OF THIS COMPONENT MUST BE ROHS COMPLIANT

TOLERANCES (EXCEPT AS NOTED)	
2 PLC. DECIMAL INCHES ±0.01	1 PLC. DECIMAL [mm] ±0.3
3 PLC. DECIMAL INCHES ±0.005	2 PLC. DECIMAL [mm] ±0.13
ANGULAR ±2°	

Eminence Speaker L.L.C.
Eminence, KY

Drawing Units: INCH/[MILLIMETER]
THIRD ANGLE PROJECTION

Title: HORN
Date Issue: 8-25-10

Drawn By: KYLE HEIGHTCHEW
Initiated By: MATT MARCUM

Scale: 0.30
Part / Dwg NO.: 55H2EA

REV: A