

Model No: SDF-300F75PR03-04  
Product Line:

Rev 1  
Last Update: 2018-06-01 08:32:52

**Product Description**

Roadmap 12inch subwoofer, Paper Cone, Ferrite Motor, AL Basket, DCR 2.8 ohm  
NOTE THIS DRIVER IS NOT APPROVED AND/OR IS NOT IN MASS PRODUCTION YET.  
AS SUCH IT MAY BE SUBJECT TO CHANGE.  
SPEC IS ONLY FOR INFORMATION.  
PLEASE CHECK STATUS WITH THE ENGINEER



**Mechanical Drawing**

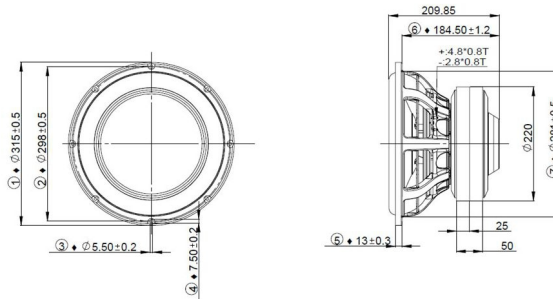

**Specifications**

DC Resistance	Revc	Ohms	3.03	5.0%	Energy Bandwidth Product	EBP	(1/Qes)*fs	77.54
Minimum Impedance	Zmin	Ohms	3.99	7.5%	Moving Mass	Mms	g	251.98
Voice Coil Inductance	Le	mH	1.33		Suspension Compliance	Cms	um/N	119
Resonant Frequency	Fs	Hz	29	15%	Effective Cone diameter	D	cm	25
Mechanical Q Factor	Qms		11.02		Effective Piston Area	Sd	cm <sup>2</sup>	490.87
Electrical Q Factor	Qes		0.37		Effective Volume	Vas	L	40.69
Total Q Factor	Qts		0.36		Motor Force Factor	BL	Tm	19.3
Ratio Fs/Qts	F	Fs/Qts	80.11		Motor Efficiency Factor	β	(T*M <sup>2</sup> )/Ohms	122.88
Half Space Sensitivity @2.83V	db@2.83V/1M	dB	86.85	+/- 1.0db	Voice coil former Material	VCfm		TIL
Half Space Sensitivity @1W/1M	db@1W/1M	dB	83.82	+/- 1.0db	Voice coil inner diameter	VCd	mm	75.55
Gap Height	Gh	mm	18		Rated Noise Power	P	W	300
Maximum Linear Excursion	Xmax	mm	18		Test Spectrum Bandwidth	40-3K Hz		
Ferrofluid Type	FF				Transducer Size	Inch		12
Transducer Mass	Kg		16.32					

**Frequency and Impedance Response**

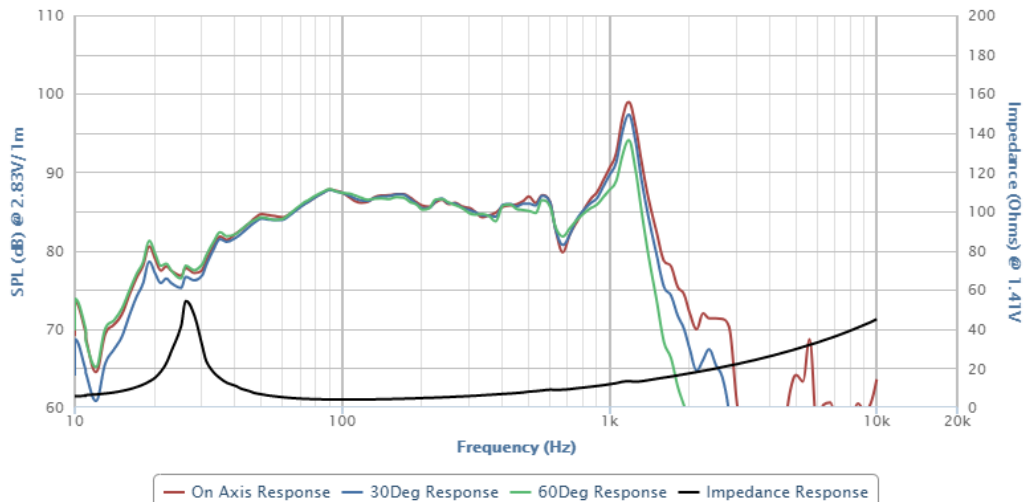

Highcharts.com