

19mm High Fidelity dome tweeter with extremely smooth and extended frequency response.

Precoated Sonotex fabric diaphragm and suspension allows for very tight production tolerances and high consistency.

Injection moulded chassis in high grade glass fibre reinforced plastic keeps the moving parts in perfect alignment and provides good coupling to the cabinet.

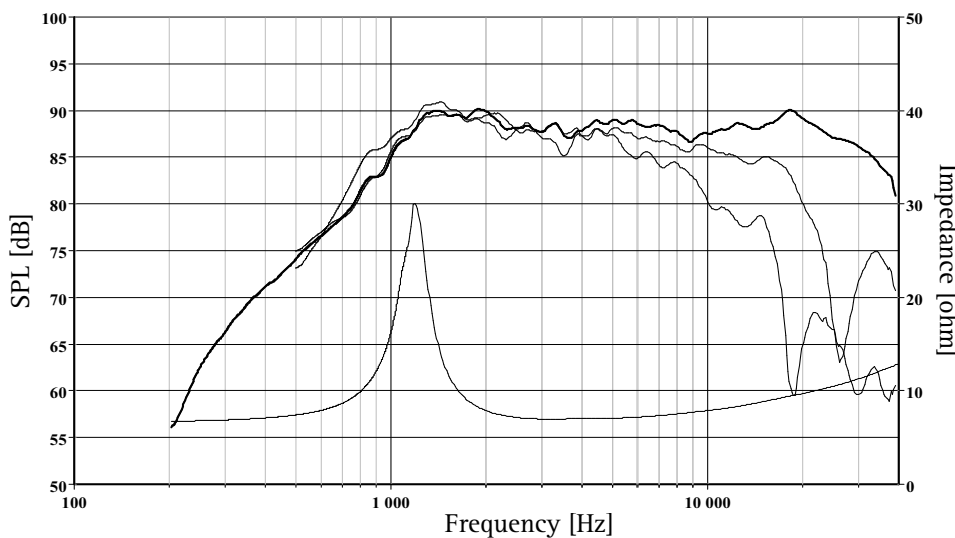

The frequency responses above show measured free field sound pressure in 0, 30, and 60 degrees, mounted in a 0.6m by 0.8m baffle. Input 2.83 Vrms, microphone distance 0.5m, normalized to SPL 1m. The impedance is measured without baffle using a 2V sine signal.

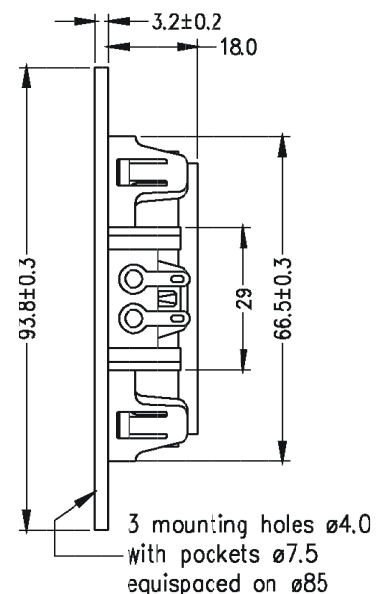

Nominal Impedance	8 Ohms	Voice Coil Resistance	6.2 Ohms
Recommended Frequency Range	4000 - 20000Hz	Voice Coil Inductance	0.05 mH
Short Term Power Handling *	220 W	Force Factor	2.9 N/A
Long Term Power Handling *	90 W	Free Air Resonance	1180 Hz
Characteristic Sensitivity (2.83V, 1m)	88 dB	Moving Mass	0.23 g
Voice Coil Diameter	19.5 mm	Effective Piston Area	4.0 cm ²
Voice Coil Height	1.5 mm	Magnetic Gap Flux Density	1.6 T
Air Gap Height	2.0 mm	Magnet Weight	0.12 kg
Linear Coil Travel (p-p)	0.5 mm	Total Weight	0.30 kg

Nov 2013

*IEC 268-5, via High Pass Butterworth Filter 2500Hz 12 dB/oct.
SEAS reserves the right to change technical data